



I'm delighted to share the results of another successful year of partnership between Charlevoix County and Michigan State University (MSU) Extension. Because of your continued support, we've been able to make a difference in the lives of youth, families, businesses, and communities.

MSU Extension offers a broad range of research-based educational outreach to county residents. Over this past year, we've empowered families and individuals to live healthier lives, supported new and local businesses, created opportunities for youth leadership development and career exploration, helped farmers with business management and mental health, and much more. We continue to innovate post-pandemic by providing our outreach online, hybrid, as well as in-person formats. These options have increased accessibility to Michigan State University resources by your residents. Our staff live and work alongside county residents, and are rooted in community relationships and responsive to community needs.

Our partnership with you makes this all possible. On behalf of the MSU Extension team serving Charlevoix County, thank you for another great year. We look forward to your continued support and hope you will be able to join us during one of our upcoming programs.

- Adam Koivisto, District 14 Director

PROGRAMS
ACCESSED BY
RESIDENTS

136

SOCIAL MEDIA
REACH

14,121

ONLINE
REACH

6,545

PROGRAMMING
REACH

1,345



4-H



Exploration Days



After having 1 year off and 1 year virtual, Exploration Days were held in person on the campus of Michigan State University June 21-24. It provides youth ages 12-19 the opportunity to experience life on a college campus. The 4-day event gives over 700 4-H members a chance to live in the dorms, experience a college setting, and be self-directing and responsible for getting themselves where they need to be. Members can choose from over 160 classes when they register for this event. This year registration was done online beginning mid-April. This year 3 4-H youth attended, participating in workshops and attended the state 4-H awards ceremony. The event is designed as a pre-college experience, and youth who will be entering the 8th through 10th grades following their involvement at Exploration Days, are eligible to apply for a \$2,000.00 scholarship, which will be applied toward the student's first year at MSU as a degree-seeking student.

Senior Scholarship

Our 2 recipients of the 4-H Senior Scholarship award this year was Maddie Graham and Kanden Behling. Maddie received a \$1000 scholarship and Kanden received a \$500 scholarship.

Maddie will be attending Ferris State University in the fall to study Dental Hygiene. Maddie has been in 4-H for over 13 years. She has held many office positions but she has held President of the Charlevoix County Council and Emmet -Charlevoix County 4-H Market Livestock Association for the last 4 years. "4-H has allowed me to make so many friends and encourage others to not only participate, but to step up and lead as well. Leadership is one of the most important skills to have in one's life and 4-H is an organization that takes pride in their leaders."

Kanden has been involved with 4-H for 14 years. He has stepped up and is the 4-H Market Livestock Associations Treasurer and has held that position for 4 years on the 4-H Charlevoix County Council. Kanden is planning on pursuing an education in construction in hopes of owning his own business in the future. "...through 4-H I have grown and developed as an individual. I have made mistakes, but then corrected and learned from them. I have become a leader and someone that many people count on when they need something."



According to research completed by the Institute for Applied Research in Youth Development at Tufts University, 4-H'ers are **4X** more likely to make contributions to their communities, **2X** more likely to be civically active, and **2X** more likely to make healthier choices.

Promoting 4-H

Charlevoix County Creature Clan 4-H Club is known for their community service. This year they took on the task of decorating a float, preparing goodies to hand out to spectators and gave their time to promote 4-H in 2 parades in Charlevoix County. They were in the Freedom Festival parade in East Jordan and 4th of July parade in Boyne City.



"It was fun being in the parades. It was a great way to tell people about 4-H and get kids excited about the 4-H" Jack



4-H Youth

Emmet-Charlevoix County Fair: This year-end event is held in mid-August and is an opportunity for 4-H youth to showcase their projects that they have been working on through the year. The 4-H projects are exhibited in the barns where clubs set up their booths to display the member's projects as well as their club's community service activities. Over 500 exhibits are on display in the barns and over 160 animal projects can be found in the many livestock barns. Members involved in animal projects are kept busy participating in the 10 horse shows, 15 livestock shows, 5 small animal shows, 2 exotic animal shows and the livestock auction. Non-competitive events are also offered for the Cloverbud members (age 5-7) and free time events included scavenger hunts (GooseChase) that went through the week. Over 30 teen leaders serve as mentors for the younger members as they serve on barn duty, and offer showmanship clinics, and adult volunteers provide leadership as barn superintendents, show days clerks, announcers, award presenters, and overnight barn duty workers. Adult and teens are also instrumental in setting



up the Exhibitor Barn the week before the fair and the tear-down of the exhibits at the end of the week. The fair is a wonderful opportunity for the 4-H members who exhibit and participate in the many fair events, but it is also a great opportunity to promote the 4-H program, the volunteer opportunities available for adults and the youth development opportunities are available to all youth in the county.



"My favorite part of fair was showing my rabbit because they are so cute" Aubrey

Investing in Charlevoix Youth with 4-H & MSU Extension

Sports and Fitness programs offer an athletic way for youth to be involved in 4-H programs to learn the sport and life skills together. Back by popular demand in the water this year was our **Boyne Area 4-H Swim School**. 66 youth ranging from Kindergarten to 8th grade took part in a 5 week class. 4-H Swim School is a nonprofit organization dedicated to providing affordable swimming instruction on Lake Charlevoix and promoting water safety to the community and surrounding areas. Thank you Charlevoix County for your continued support of 4-H programs! We are blessed with many lakes and rivers in Charlevoix County and providing the youth the swimming skills to be safe while having fun in outdoor swimming experiences is key. Our amazing Boyne Area 4-H Swim School Staff are trained and certified by The American Red Cross in: Life Guarding and CPR/First Aid /AED.



4-H Soccer offers a spring and fall recreational soccer experiences in Boyne City and a fall in East Jordan. Averaging 130 kids in the spring and over 300 kids in the fall between the two different programs. We are fortunate to have over 50 adult 4-H Volunteers who step up to help coach and be positive role models to the 4-H youth in the county.

Summer of 2022 brought back our popular **4-H Tennis Clinics**. Our seasoned program director of 15 years along with 10 4-H youth teen Instructors taught 43 youth the fundamentals of tennis and playing fun games to learn the rules. We offered two different levels of experience sessions so youth who had more experience could learn more of the competitive play of tennis.



Participation in sports, including swimming, soccer and tennis offers benefits that are consistent with elements of positive 4-H youth development. Studies have shown that exercise and fitness helps youth develop physical competence, a positive self-image, social skills, cooperation, teamwork skills, and determination.



Take A Day On

Charlevoix County 4-H youth participate in the Annual community service learning project called TAKE A DAY ON! This is an event where youth get to take a day off of school and take a day on for an organization in their local community.

The event this year was on Thursday, May 5th at Charlevoix Rod & Gun Club . 18 youth and 7 adults attendance this year. The Charlevoix Rod and Gun Club is located on 130 picturesque acres. There objective is to advance the protection, propagation, and conservation of fish, game, birds, in both state and nation; To procure the enactment of laws for the preservation of fish, game, birds and forests.; to do everything possible to eliminate pollution of our waterways from the standpoint of public health, scenic beauty and as an economic measure; to interest the general public in the sportsmanlike methods of taking fish, game and birds; to teach and promote the safe use of sporting archery and firearms; to bring about friendly relations between sportsmen and The youth and volunteers were broken up into groups and began packing lunches, raking, spreading mulch, setting t-posts, picking up clay pigeons. They got to have lunch in the club house before releasing the rainbow trout into the pond for the youth day the Charlevoix Rod and Gun clubs has every year. The youth also donated ear protections and safety glasses to the Rod & Gun Club.



Actively Enrolled
865 Youth
100 Volunteers

AGRICULTURE



MSU Extension facilitates the growth of agriculture, Michigan's second largest industry. Locally, we help our farmers increase their efficiency and productivity through on-farm research as well as individual programming such as the Farm Stress Program and Farm Management consultations. We also serve the agriculture industry by connecting our producers to MSU faculty and experts across the State to identify solutions to their production challenges. In addition to serving farmers, we also serve the sportsman, home gardeners, and the general population at large by providing consultation, expertise, and education in agriculture related ventures.

Northern Michigan has so much to offer in terms of its natural resources. Our counties are homes to beautiful woods and waters, as well as many acres of productive farmland. In addition to growing the food that feeds many families across our towns, our state, and our nation, our farms are also the livelihood of many families that call our counties home. Agriculture is an essential component of building and maintaining rural economies. As an organization, we work diligently to provide our local farms with up to date, useful information, and research that contributes to their growth, economic security, and environmental sustainability.

Farming in Northern Michigan poses challenges that are unique to our area. Because of these unique challenges and isolation from many agricultural services, MSU Extension works to bridge the gap between our farms, and other areas of agriculture that our farms compete with. One way we help our farms in this respect is through multiple on-farm research projects. These local research projects give our area producers management and crop variety data that is specific to our area. No two farms are alike, therefore providing this data on the local level helps our county's farmers to be more competitive and more profitable.

Supporting MSU Extension also gives our local producers increased access to information and expertise from faculty and specialists within Michigan State University's College of Agriculture and Natural Resources. In turn, faculty and specialists also receive insight into issues facing agriculture in our area, which can aid or steer their research, to our local benefit. We also work to inform our area producers and agribusiness professionals of current issues facing agriculture through multiple forms of communication including newsletters, press releases, grower meetings, field days, and web meetings. This helps our producers to be prepared for any production issues that can affect their farms.



2021-2022 FY Highlights Utilized by Charlevoix County Residents:

Heroes to Hives Courses

Beef Quality Assurance Certification

MI Ag Ideas to Grow With Confidence

Cabin Fever Conversations

MI Great Beer State Conference and Trade Show

MSU Extension works to increase farmers' success while protecting the environment, ensuring food safety, reaching new markets and advancing agriculture through applied research. Agriculture is now one of the fastest growing sectors of the Michigan economy.

CHILD & FAMILY DEVELOPMENT

- **Playgroups** for families with children birth-five. The purpose of playgroup is for families to come together and interact with one-another and their children in a family friendly manner. Children can rotate between different stages of activities set up throughout the playgroup. I brought marketing materials, handouts with information relating to the different developmental domains as well as, a book for the families who attended playgroup to have. There were 13 families and 19 children ranging from birth through early school entry who attended these playgroups.

Charlevoix Playgroup: 5 families, 6 children ranging from birth through 2.

Boyne City Playgroup: 7 families, 11 children ranging from birth through early school entry.

Central Lake Playgroup: 1 family, 2 children ranging from birth through preschool.

- **Charlevoix Programming** I offered a wide range of one-time and series workshops including positive discipline, mindfulness, building social emotional skills, guiding principles for highly successful families, reducing challenging behaviors, development of self-control, parent talk and RELAX alternatives to anger. Out of these courses, there were 6 residents from Charlevoix County who participated.

Building Early Emotional Skills (BEES); 1 Charlevoix Resident

Mindfulness for Children: Helping Children Manage Stress; 1 Charlevoix Resident

Positive Discipline; 3 Charlevoix Residents

Parent Talk; 1 Charlevoix County Resident

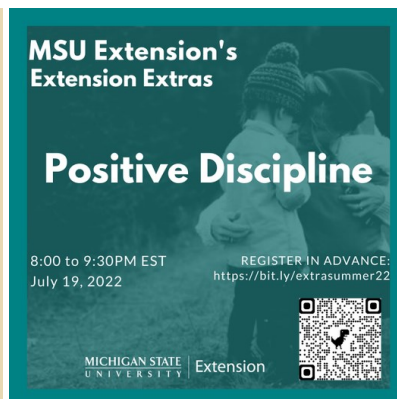
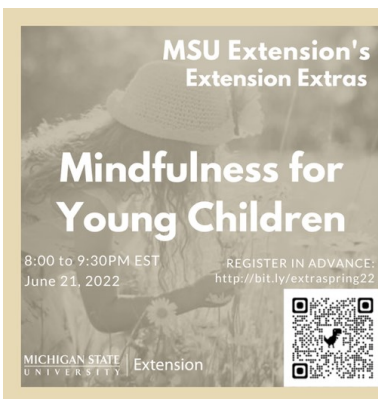

Keeping Michigan families strong and successful—financially, emotionally and physically—is a big part of measuring MSU Extension's success. Programs devoted to keeping families safe include those dealing with bullying and violence prevention.

FOOD & HEALTH



We are very pleased to announce that Jane Sherry joined our MSU Extension team. Jane began her journey with us on August 8th 2022:

"Hi, my name is Jane Sherry, and I am the new Community Nutrition Instructor for MSU Extension, based in Gaylord. I will be teaching classes on nutrition and physical activity in three counties: Otsego, Charlevoix, and Emmet. I am passionate about helping others to make healthy decisions for themselves. I look forward to making a difference in my community!"
Jane



Health & Nutrition Classes

Tai Chi
Chronic Pain Self-Management
Chronic Disease
Matter of Balance

MSU Extension's programming promotes healthy lifestyles and empowers Michigan residents to take control of their health. Participants learn how to build nutritious diets on a budget, reduce foodborne diseases and become leaders in the food industry.

Beaver Island Environment

Ecology Workshop

On Monday, July 11, MSU Extension Educator Erick Elgin and MSU Department of Fisheries and Wildlife faculty Dr. Jo Latimore delivered a day-long Inland Lake Ecology workshop on Beaver Island in Charlevoix County.

Approximately 18 people participated, including a mix of island residents and visiting college students.

During a classroom session, participants learned how they can monitor the health of their lakes through the MI Corps Cooperative Lakes Monitoring Program; how to protect healthy nearshore habitat in lakes; the diversity of aquatic plant life on the island; and how to identify and prevent the introduction of aquatic invasive species.

Many participants then accompanied the instructors to Barneys Lake to further study aquatic plants and lake ecology.

Elgin and Latimore spent the following day touring the island's lakes with residents and exchanging ideas about inland lake conservation.

The workshop was held in partnership with the Beaver Island Archipelago's Terrestrial Invasive Species Program, the Beaver Island Association, and the Central Michigan University Biological Station.



Our natural resources programs improve public understanding, help landowners and communities use those assets for sustainable long-term social and economic development and conserve natural resources for future generations.

Beaver Island Sustainability

Sustainability Fair

Supervising and Staff Development educator Sandra Westover attended the 2022 Beaver Island Sustainability Fair on Saturday June 25th, 2022. She toured their food pantry and plans to connect the pantry leadership to our new Community Nutrition Instructor to begin a partnership. We are hoping the partnership will result in free nutrition and physical activity presentations and/or series for those that utilize the pantry. Sandra also spoke about other resources MSU Extension has to offer such as our Master Gardener Program, Food Safety Hotline, and Food Preservation presentations /series.



Join us for the 7th Annual
**Beaver Island
Sustainability Fair!**
Saturday, June 25

Morning: Paradise Bay Park at the Lake
900am: Water Blessing & Cairn Stone Ceremony
1030am: "Urban Grazing" Garden Walk

Afternoon: Gregg Fellowship Hall, BI Christian Church
12noon: Traditional Feast-white fish, corn soup, fry bread, dessert
1230pm: Welcome & Environmental Award
1:00pm: Loveable Loo compost toilet & Cistern demo - GVSU
145pm: Local Foods Presentations
215pm: Smart Energy Presentations
245pm: Play "Native or Invasive Species?" Game! Raffle Drawing #1
300pm: Ecology & Culture Presentations
415pm: Raffle Drawing #2, Closing Ceremony

600pm: Harbour Bodega - Optional Dine & Music
7:30pm: Print Shop Museum - Dark Sky Project Film
900pm: Donegal Bay Pavilion - Dark Sky Viewing, Music, Stories
(program times are approximate)

Follow the Fair: Facebook @ Beaver Island Sustainability Fair
Volunteers, Food & Artist Vendors Welcome!
Contact: sally.tarasmeadow@gmail.com, 231-245-6237



Photos above and below: "Urban Grazing" garden walk with Island gardener Heidi Vigil

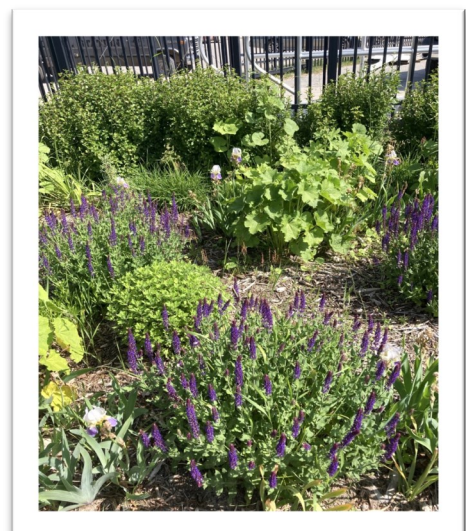

Photo to the Left: For lunch we were served a traditional feast of white fish, corn soup, fry bread, and dessert.

Charlevoix County Office

This past year, Charlevoix County MSU Extension has helped community members through phone, email, Facebook and office walk-ins.

Call, email, follow us on Facebook or stop in.

- **231-582-6232**
- **msue.charlevoix@county.msu.edu**
- **Facebook — @charlevoixcountymsuextension**
- **319B North Lake Street, Boyne City, MI 49712**

As MSU Extension continues to bring research and education to citizens across the state, three wonderful resources help reach every community member in our counties:

- **Ask Extension** offers one-to-one answers from MSU Extension experts and Extension Master Gardener volunteers on topics such as lawns, gardening, agriculture, food safety, food preservation, natural resources, community development, youth programming and more! Visit Ask Extension at:

<https://www.canr.msu.edu/outreach/ask-an-expert>

- **The MSU Extension Lawn and Garden Hotline** is made up of Extension Master Gardeners with the knowledge and resources to help community members with questions from “What plant is this?” to “What’s eating my flowers?”

Call the hotline at: (888) 678-3464

When in doubt, a quick call, email, or stop by the Charlevoix County MSU Extension office is always a great idea. Office Manager Tasha Furgeson is at the office Monday - Friday 8:30am - 4:30pm to use the resources of MSU Extension experts, articles, and research to help find answers to any of your questions.

**Resources
at your
Fingertips**



231-237-4441

furgeso2@msu.edu

CONTACT US:

Charlevoix County MSU Extension

319B North Lake Street

Boyne City, MI 49712

PHONE: (231) 582-6232

EMAIL: msue.Charlevoix@County.msu.edu

WEB: www.canr.msu.edu/charlevoix



STAFF HOUSED IN CHARLEVOIX COUNTY :

Name:	Role:	Phone:	Email:
Adam Koivisto	District 14 Director	(231) 237-4775	koivist4@msu.edu
Leah LaVanway	4-H Program Coordinator	(231) 225-0216	ljl4211@msu.edu
Danielle Melching	Early Childhood Instructor	(231) 624-8090	melchin4@msu.edu
Tasha Furgeson	Office Manager	(231) 237-4441	furgeso2@msu.edu

ADDITIONAL CONTACT NAMES

Name:	Role:	Phone:	Email:
Julie Crick	Forestry Educator	(989) 275-7179	crickjul@msu.edu
Sienna Timm	Supervising Ext Educator Children & Youth Institute	(989) 354-9877	suszek@msu.edu
Brandon Schroeder	Sea Grant Extension Educator	(989) 354-9885	schroe45@msu.edu
Mary Dunckel	Agriculture Literacy Educator Innovation Counselor MSU Product Center	(989) 354-9875	dunckelm@msu.edu
Phil Durst	Sr. Extension Educator Dairy & Beef	(989) 387-5346	durstp@msu.edu
Wendy Wieland	Innovation Counselor MSU Product Center	(231) 439-8987	wieland5@msu.edu

MISSION:

Michigan State University Extension helps people improve their lives through an educational process that applies knowledge to critical needs and issues and opportunities.

MSU is an affirmative-action, equal-opportunity employer, committed to achieving excellence through a diverse workforce and inclusive culture that encourages all people to reach their full potential. Michigan State University Extension programs and materials are open to all without regard to race, color, national origin, gender, gender identity, religion, age, height, weight, disability, political beliefs, sexual orientation, marital status, family status or veteran status.